

Elevator Guide Rails

Designed and produced in compliance with ISO 7465 standard, our machined elevator guide rails are suitable for use in elevators with velocities up to 350 fpm (for **V350 Series**) and 750 fpm (for **V750 Series**)

GUIDE RAILS V350

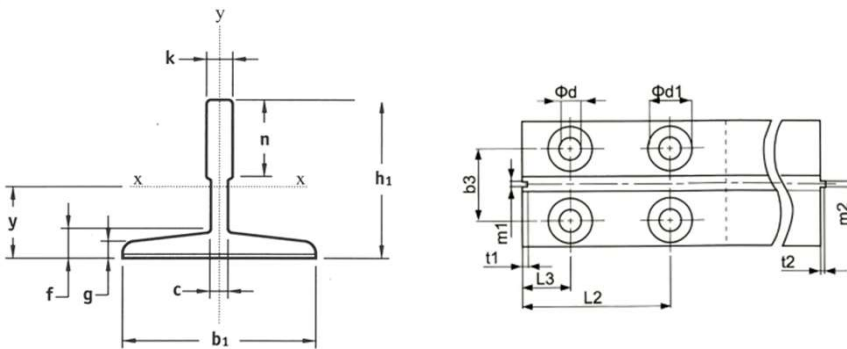

Guide Rail Type	b1	h1	k	n	c	f	g
	Tolerances (all dimensions in inches)						
	±0.06	±0.03	+0.004	+0.12			
T89/B	3.5	2.44	0.625	1.3125	0.375	0.4375	0.313
T127-1/B	5.0	3.5	0.625	1.75	0.375	0.4375	0.313
T127-2/B	5.0	3.5	0.625	2.0	0.375	0.625	0.50

Note: Other guide rails available upon request

FISHPLATES

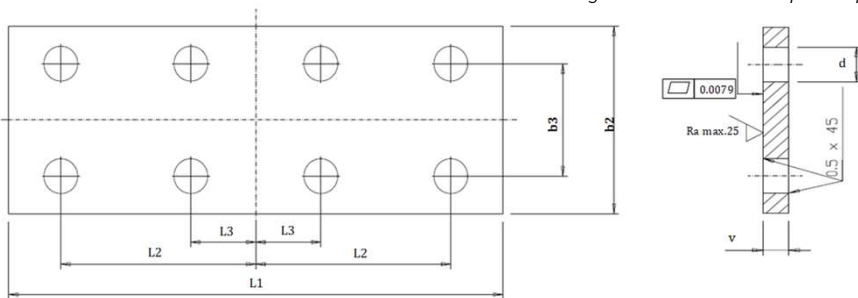

Guide Rail Type	d (in)	b2±0.059 (in)	b3±0.008 (in)	L1 +0.12 -0.059 (in)	L2±0.008 (in)	L3±0.008 (in)	v+0.12 (in)
T89/B	0.5625	3.5	2.25	12.0	4.5	1.5	0.63
T127-1/B	0.6875	5.0	3.125	12.0	4.5	1.5	0.75
T127-2/B	0.6875	5.0	3.125	12.0	4.5	1.5	0.75

Note: Seismic fishplates available upon request

Chemical Composition

C%	Mn%	P%	S%	Si%
≤0.22	≤1.40	≤0.045	≤0.05	≤0.35

Mechanical Properties

Tensile Strength (kpsi)	Yield Point (kpsi)	Elongation (%)
53.6 ~ 72.5	34.0	≥ 26

Blade roughness

longitudinal Ra 63µin
transverse Ra 126µin

Twisting

$\gamma = 9.1'/ft$

Perpendicularity

$\alpha = 5'$
 $\beta = 15'$

Straightness

B/A = 0.001 in
B/16' = ± 0.08 in

Parallelism

p = 0.004 in

Tongue and groove centering

c = 0.004 in